

OUTPARCEL AVAILABLE

METRO POINTE

5920 Metropolis Way, Orlando, FL 32811

5,000 SF PROPOSED RETAIL OUTPARCEL AVAILABLE

- Property is adjacent to Super Wal-Mart
- Great visibility and access from Kirkman Rd.
- Join other national tenants such as Dollar Tree, Cato, Sally Beauty, and Planet Fitness
- 33,000 SF shopping center
- Traffic Counts:
Kirkman Road – 57,500 AADT
Metrowest Blvd. – 19,000 AADT

DEMOGRAPHICS	1 mile	3 mile	5 mile
Population	26,723	113,305	284,373
Avg. HH Income	\$53,015	\$58,162	\$59,929
No. of Businesses	468	4,156	10,453
Daytime Population	4,805	52,412	161,434



Casey Dorner
office (407) 426-2300 Ext. 110
cell (407) 404-4017
caseydorner@libertyum.com

314 East Anderson St.
Orlando, FL 32801
www.libertyum.com

Offer subject to withdrawal from the market, due to prior sale or cancellation without notice. All information contained here in is believed to be accurate but is not warranted.

SURROUNDING RETAIL

METRO POINTE

5920 Metropolis Way, Orlando, FL 32811



Casey Dorner
office (407) 426-2300 Ext. 110
cell (407) 404-4017
caseydorner@libertyum.com

314 East Anderson St.
Orlando, FL 32801
www.libertyum.com

Offer subject to withdrawal from the market, due to prior sale or cancellation without notice. All information contained here in is believed to be accurate but is not warranted.

SITE MAP

METRO POINTE

5920 Metropolis Way, Orlando, FL 32811

TENANT ROSTER

5944	SPECTRUM	3,850 SF
101-104	SANITAS	6,000 SF
105	PAPAS GYROS	1,454 SF
106-107	METRO BY TMOBILE	2,905 SF
108-116	PLANET FITNESS	13,000 SF
117	LORA B SALON	1,451 SF
118-119	SILVA'S MARKET	2,900 SF
120-122	OWN IT NOW	4,828 SF

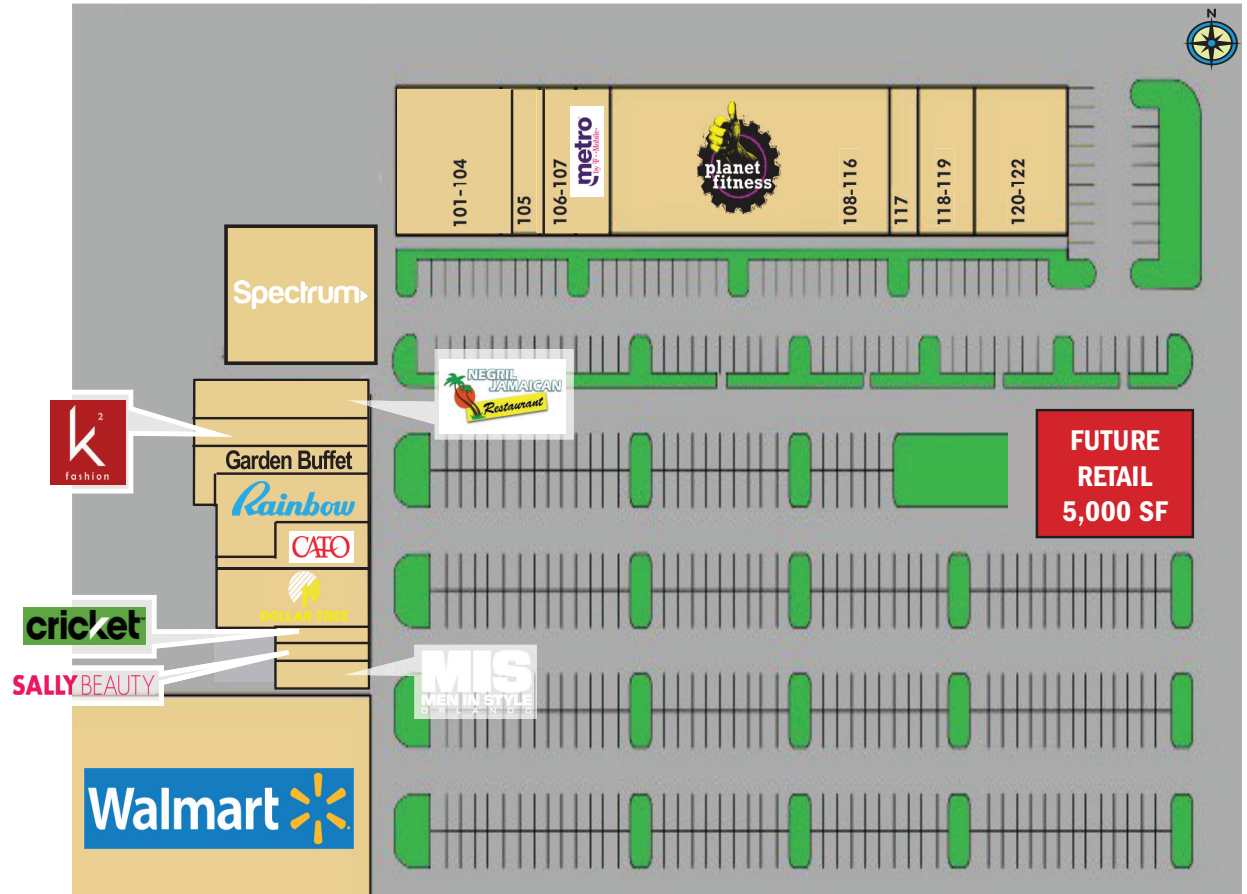
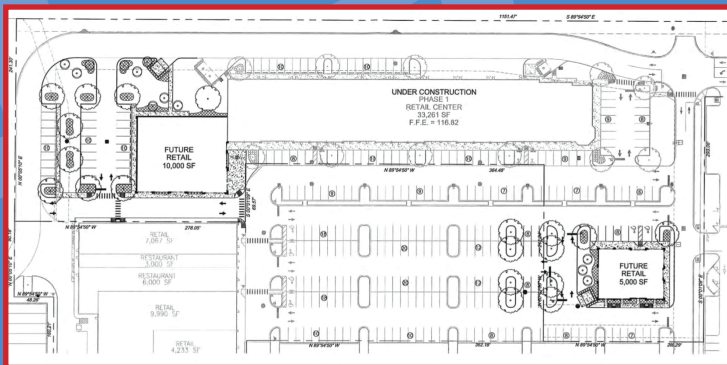

Casey Dorner
 office (407) 426-2300 Ext. 110
 cell (407) 404-4017
caseydorner@libertyum.com

314 East Anderson St.
 Orlando, FL 32801
www.libertyum.com

Offer subject to withdrawal from the market, due to prior sale or cancellation without notice. All information contained here in is believed to be accurate but is not warranted.